

# MGTL022V

## Bi- Telecentric Lens

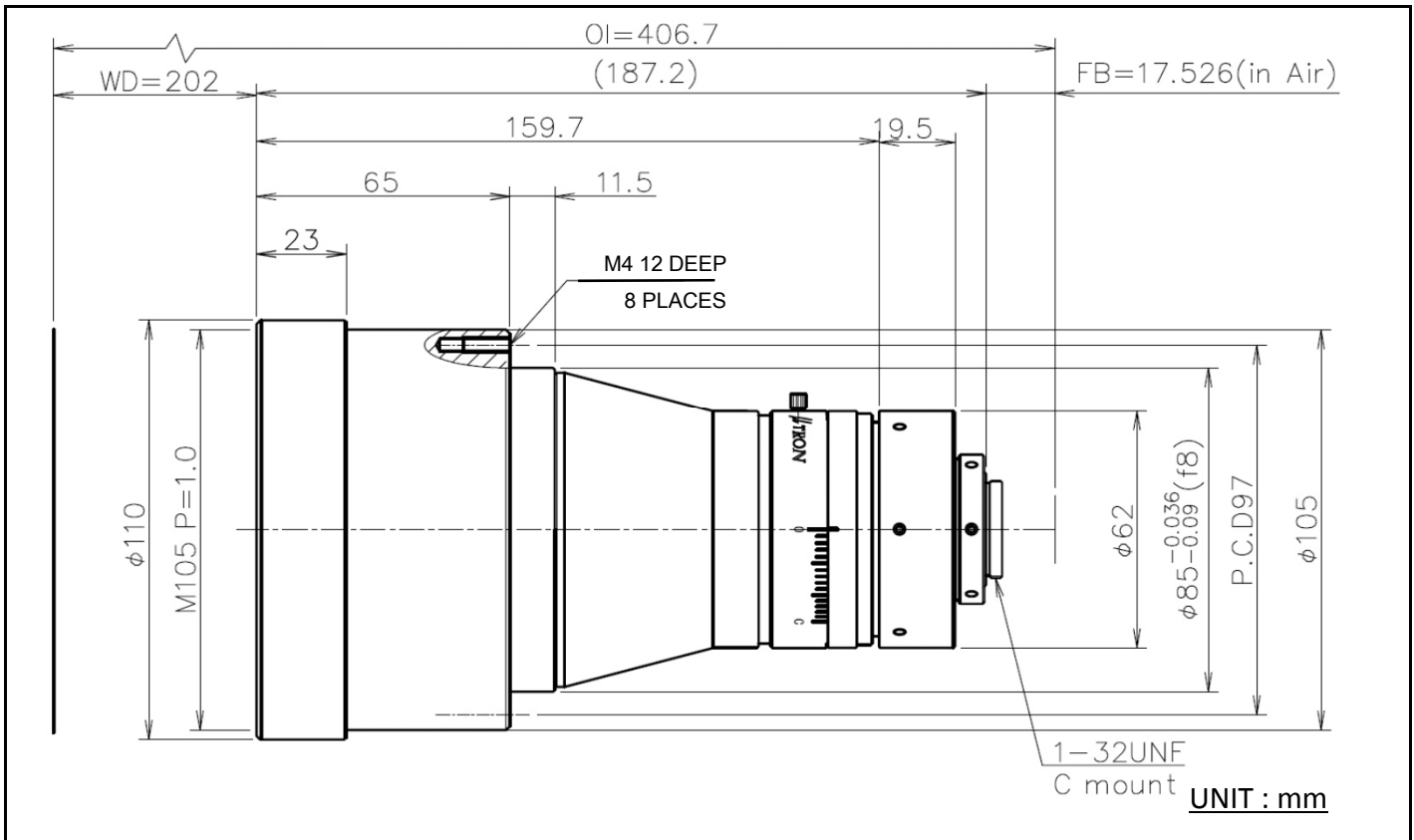

<b>Model</b>	MGTL022V
<b>Magnification</b>	0.22x
<b>W D</b>	202.0 mm
<b>O I</b>	406.7 mm
<b>Effective FNo.</b>	6.0
<b>Object Side NA</b>	0.018
<b>Object Side Resolution</b>	18 μm
<b>Depth of Field</b>	9.9 mm
<b>TV Distortion</b>	0.00%
<b>Image Circle</b>	φ 17.6 mm
<b>Weight</b>	Approx. 1.4kg
<b>Mount</b>	C-mount
<b>Filter Size</b>	M105 P=1.0

°Specifications mentioned above are design values.

°Resolution indicates a theoretical resolution at a wavelength of 550nm.

°Depth of field is calculated assuming permissible circle of confusion is 40 μm.

°Specifications and dimensions are subject to change without notice.