

# MGTL0345V Telecentric Lens for 1.1 inch

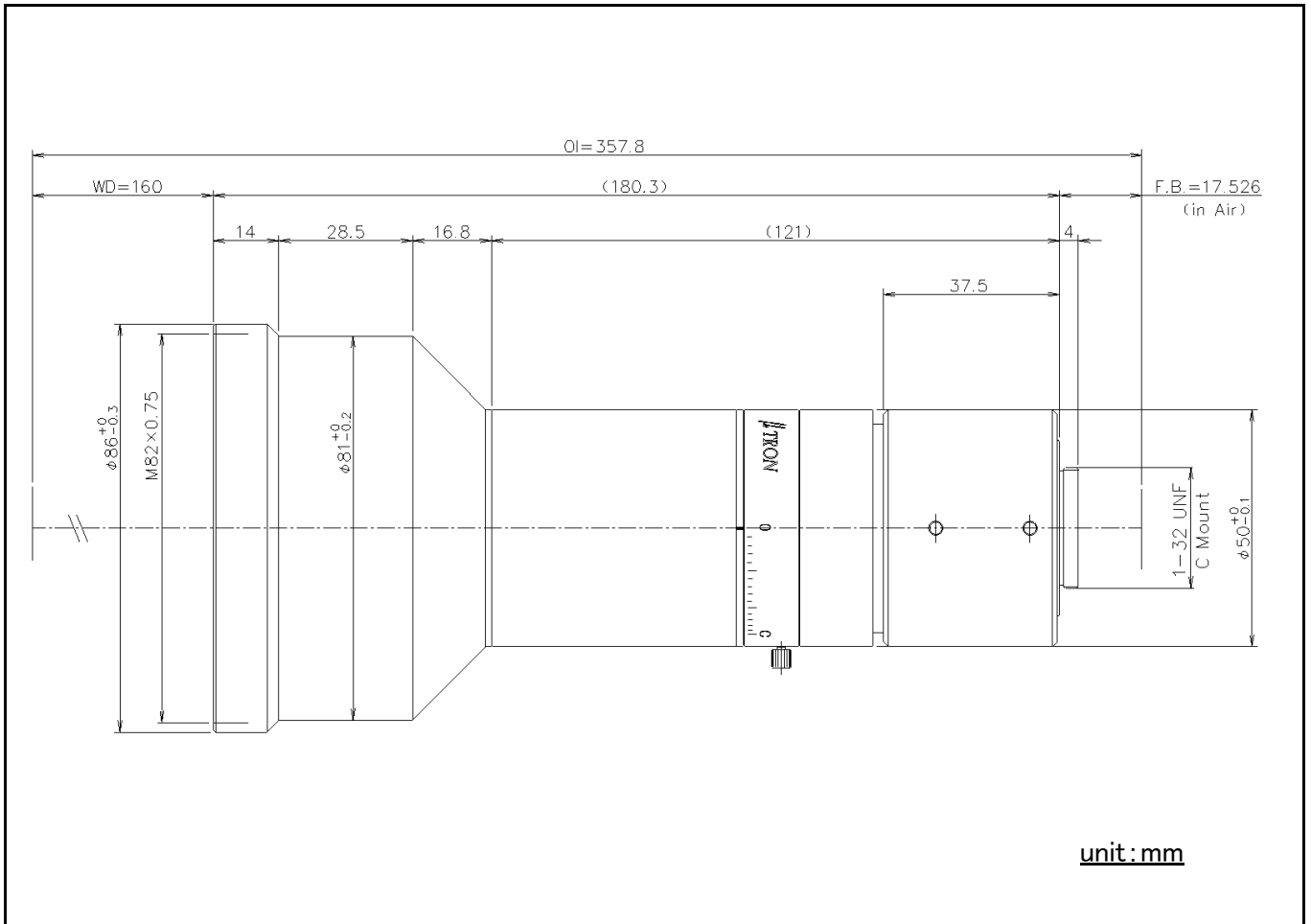

Model	MGTL0345V
Magnification	0.345X
W D	160.0mm
O I	357.8mm
Effective F No.	4.8
Object side NA	0.036
Object side Resolution	9.3 $\mu$ m
Depth of Field	3.2mm
TV Distortion	0.00%
Maximum Compatible Sensor	$\phi$ 18.4mm
Weight	Approx. 870g
Mount	C Mount
Filter Size	M82 P=0.75

- Specifications mentioned above are design values.
- Resolution indicates a theoretical resolution at a wavelength of 550nm.
- Depth of field is calculated assuming permissible circle of confusion is 40  $\mu$  m.
- Specifications and dimensions are subject to change without notice.